

Promenade Maps. Figure 1 shows the Park in context, with the **Lake Boren Trail** around the lake. The east shore **Promenade** (Figure 2) completes the trail & expands the park. See **sketch** on page 3.

Geography. The original park (light green in map) is distant from the dense population north and east in apartments and retirement homes (Aegis & Regency). The Promenade gives these folk a short walk to a big waterfront park. The new Boardwalk completes the **CrossTown Trail** (yellow).

History. Newcastle's Comprehensive Plan shows that residents wanted trails, parks, and nature (animals, trees, and meadows). In our earliest public meetings, residents asked for more public waterfront on their lake, and a shoreline trail (Lake Boren Trail) around it. The Promenade will complete the trail, expand the park, and greatly expand the walkable waterfront.

Figure 1. Lake Boren Trail (green) with viewpoints V on east shore Promenade segment

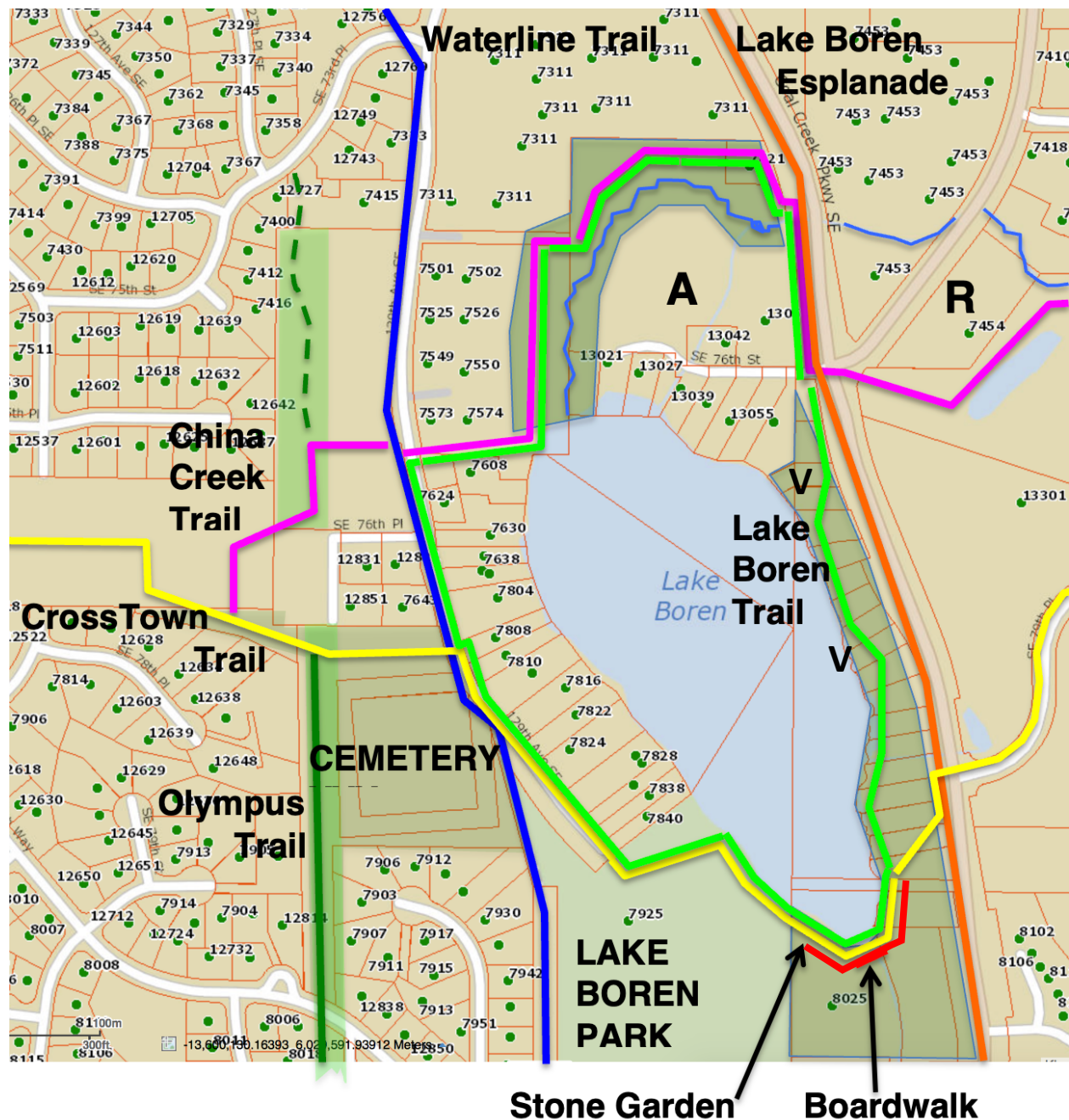

Figure 2. Map N of Park Master Plan with Lake Boren Promenade (green) on east shore.



Note: The map includes items (41-46) suggested by others. I'd give top priority to the trail (31), then trees & site finishings (41 & 37), then viewpoints with shaded benches (42-43). - G. Kampen 3/3/24

Priority

- 1 31 Lake Boren Promenade (5' asphalt) completes Lake Boren Trail around lake.
- 4 32 Lake Boren Promenade Boardwalk (north section; south Boardwalk **done** by May)
- 5 33 Promenade Deck (a fishing dock; roof-bench pavilions 43-44 might get more use)
- 6 34 Lake Boren Stairs

Done 35 Lake Boren Dock (swimming dock, **done**)

Done 36 Accessible Lake Boren Connection (south Boardwalk & 36 **done** by May 2024)

2 37 Site Finishings (benches, picnic tables, etc.) [**no map location:** applies to entire site]

2 41 Forest (evergreen trees along Parkway, grass and flowering shrubs near the lake)

3 42 Overlook (overlook with benches, roof, wall facing Parkway)

3 43 Moon Viewing Pavilion on the lakeshore (benches, roof, railing)

Future 44 Public Art (in forest glades near trail; temporary or permanent displays)

Future 45 Climbing wall (also a sound barrier; visible from lake; for climbers & viewers)

Future 46 Coal Car Display (a coal car or replica/artwork could mark the SE park entrance)

Goals:

1. Add the east lakeshore to the park with the Promenade (31) and amenities for walkers.
2. Complete the Lake Boren Trail around the lake close to the public lakeshore.
3. Provide quicker, easier access to park for residents east and north of the park. Residents of the Aegis and Regency retirement homes will have easy access to viewpoints (42 & 43).

Promenade Sketch from Lake Boren Park Master Plan.

